

# New Castle/Henry County Industrial Park



## NEW CASTLE/HENRY COUNTY ECONOMIC DEVELOPMENT CORPORATION

Community Center  
100 South Main, Suite 203  
New Castle, IN 47362

Phone: 765-521-7402

Fax: 765-521-7404

E-mail: [bcoats@midwestdevelopment.org](mailto:bcoats@midwestdevelopment.org)

Website: [www.midwestdevelopment.org](http://www.midwestdevelopment.org)

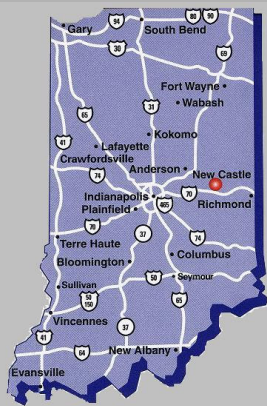

**HENRY COUNTY IS THE PERFECT  
LOCATION AND TYPE OF COMMUNITY TO RAISE A FAMILY, WORK  
AND  
ENJOY MANY RECREATIONAL**

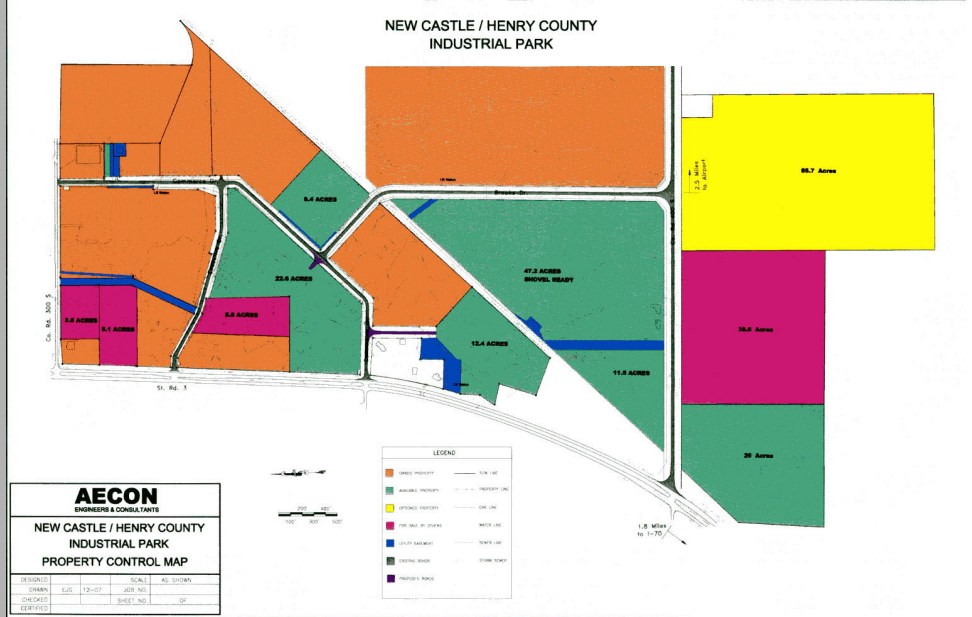

**Location:**

Located on State Road 3 (a divided 4 lane highway) at County Road 300 and 400 South

**Total Park Size:**

260 Acres

**Available Land:**

186 Acres Total (65.7 / 47.2 / 26 / 22.6 / 12.4 / 11.5)

**Zoning:**

I-1 (Light Industry)

**Price:**

\$8,000—\$15,000 per Acre

**Utilities:**

**Electric:**

Powered by Henry County REMC

**Gas:**

Provided by Vectren with a 4" high pressure line

**Water:**

Provided by New Castle Utilities with a 12" main

**Sewer:**

Provided by New Castle Utilities with a 36" line

**Transportation:**

**Air:**

New Castle Municipal Airport with a 4000 ft runway, expanding to 5000 ft

Indianapolis, IN International Airport – 55 miles

Dayton, OH International Airport – 60 miles

Cincinnati, OH International Airport – 95 miles

2.5 miles to Interstate 70, and less than 30 minutes to I-465

**Highway:**

**Rail:**

None available at site

**Taxes:**

See web site for information:

[www.midwestdevelopment.org](http://www.midwestdevelopment.org)

**Police:**

New Castle Police Department

**Fire:**

New Castle Fire Department